



8611 Series Double Adjustable Strut Inserts

The 8611 Series double adjustable strut insert is a twin-tube hydraulic that is externally adjustable in both rebound and compression damping. This is an affordable double adjustable option for club racers and autocrossers in North America for vehicles utilizing strut suspensions. The rebound valving is adjustable at the top of the strut rod with a knob that is included while the compression adjuster is located at the bottom of the insert. This requires a 1/2" diameter hole to be made in the

bottom of the strut housing for access to the adjuster. The 8611 Series is not supplied with a threaded locknut to retain the insert into the strut housing. If new locknuts are required for your application, please refer to the chart below to determine which part number you need when placing your order. Bump rubbers are included with the inserts though not shown in the drawing.



| Part Number | Stroke | Max L | Min L | A | D |
|----------------|--------|-------|-------|-------|--------|
| 8611-1256 Race | 139mm | 520mm | 380mm | 311mm | 45.5mm |
| 8611-1257 Race | 143mm | 500mm | 357mm | 290mm | 43.5mm |
| 8611-1258 Race | 158mm | 615mm | 457mm | 391mm | 43.5mm |
| 8611-1259 Race | 153mm | 540mm | 387mm | 332mm | 43.5mm |

| Stroke | Max L | Min L | A | D |
|--------|--------|--------|--------|-------|
| 5.47" | 20.47" | 14.96" | 12.24" | 1.79" |
| 5.63" | 19.69" | 14.06" | 11.42" | 1.71" |
| 6.22" | 24.21" | 17.99" | 15.39" | 1.71" |
| 6.02" | 21.26" | 15.24" | 13.07" | 1.71" |

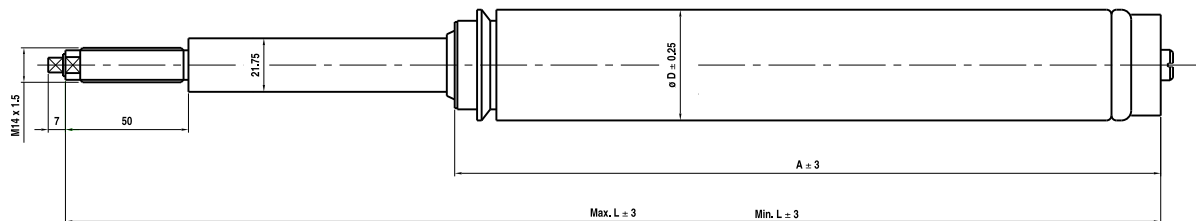

8610 Series Single Adjustable Strut Inserts

The 8610 Series strut cartridge insert fits a variety of road racing and autocross cars. This insert offers externally adjustable rebound damping with unique valving characteristics that have been developed in conjunction with many top racing teams and chassis builders. The piston rod is designed to fit through a 5/8" bearing/

camber plate assembly. The 8610 Series is not supplied with a threaded locknut. Please specify which of the following part numbers you need from the chart below when placing your order. Bump rubbers are included with the inserts though not shown in the drawing.

| Part Number | Stroke | Max L | Min L | A | D |
|----------------|--------|-------|-------|-------|--------|
| 8610-1436 Race | 143mm | 500mm | 357mm | 290mm | 43.5mm |
| 8610-1437 Race | 153mm | 540mm | 387mm | 332mm | 43.5mm |

| Stroke | Max L | Min L | A | D |
|--------|--------|--------|--------|-------|
| 5.63" | 19.69" | 14.06" | 11.42" | 1.71" |
| 6.02" | 21.26" | 15.24" | 13.07" | 1.71" |

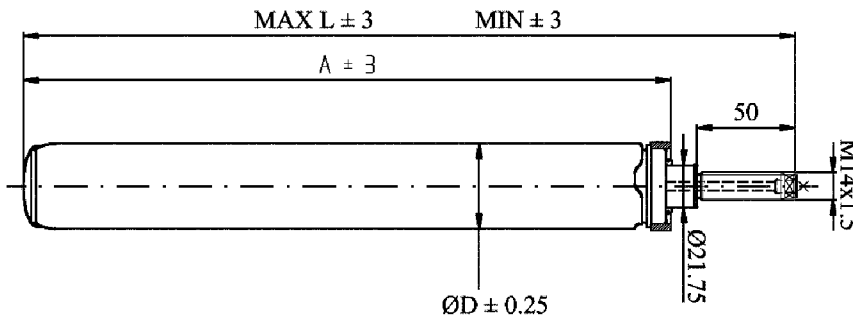

| THREAD & PITCH | PART NO. |
|----------------|----------------|
| M48 x 1.50 | 73.25.01.003.1 |
| M48 x 1.00 | 73.25.01.002.1 |
| M51 x 1.25 | 73.25.01.006.1 |
| M51 x 1.50 | 73.25.01.007.1 |
| M52 x 1.50 | 73.25.00.025.1 |
| 52.8WW | 73.25.01.011.1 |

TO DETERMINE THE CORRECT 8611 OR 8610 INSERT FOR YOUR APPLICATION

FOLLOW THESE STEPS.

- Measure the inside depth and inside diameter of your strut housing.
- For the KONI insert to be properly installed, the measure depth of your strut housing must be 1-4mm (.04"-.16") shorter than the dimension "A" in the chart below. Also, the inner diameter of the housing must be larger than the dimension "D".

- In the event that the KONI "A" length is shorter than the required, the user must then fabricate a spacer and place it under the KONI insert so as to achieve the proper depth relationship.
- After the KONI insert with the correct "A" length has been determined, verify that the stroke length will be appropriate for your application.

NOTE: See page 13 for camber plate notes.